

**General:**

Meets requirements for 1 - 25 ampere switching of resistive loads to .75 power factor at voltages to 600 V AC and 250 V DC resistive loads



**Electrical:**

- \* Ratings:
  - 25A/120 VAC
  - 15A/600 VAC
  - 20A/600 VAC (RESISTIVE)
  - 3A/125 VDC
  - 1A/250 VDC

- \* Current carrying capacity: 30 amperes
- \* Dielectric Withstanding Voltage: 2200 Vrms
- \* Contact Resistance: Initial, 10 milliohms max.
- \* Insulation Resistance: 100 Megohms min., Initial

**Mechanical:**

- \* Sections: 8
- \* Positions: 3
- \* Circuit: See Contact Table and Stator Diagram
- \* Nonshorting Operation
- \* Indexing: 45° positive detent
- \* Rotational Life: 65,000 operations

**Materials and Finishes:**

- \* Rotors and Stators: Thermoset Plastic, UL 94V0
- \* Rotor contacts: Phosphor bronze
- \* Stator contacts: Silver plated copper, screw type
- \* Terminal hardware: silver plated brass
- \* Exterior Metal: Steel with zinc chromate finish
- \* Knob: thermoset phenolic

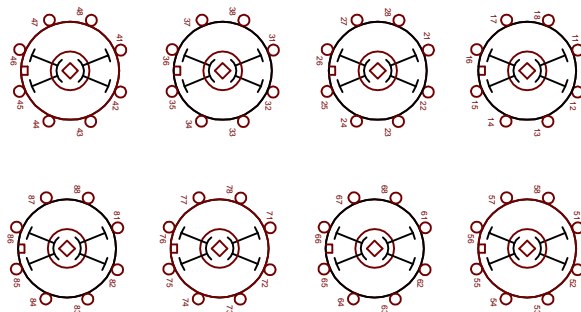
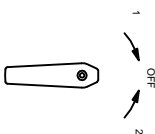
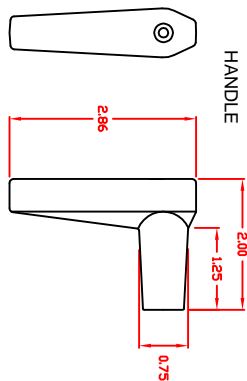

DECK	CONTACTS	POSITION		DECK	CONTACTS	POSITION	
		1	2			1	2
1	18	—	—	5	58	—	—
	19	—	—		59	—	—
	20	—	—		60	—	—
	21	—	—		61	—	—
2	22	—	—	6	62	—	—
	23	—	—		63	—	—
	24	—	—		64	—	—
	25	—	—		65	—	—
3	26	—	—	7	66	—	—
	27	—	—		67	—	—
	28	—	—		68	—	—
	29	—	—		69	—	—
4	30	—	—	8	70	—	—
	31	—	—		71	—	—
	32	—	—		72	—	—
	33	—	—		73	—	—

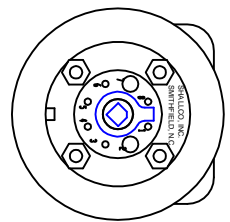
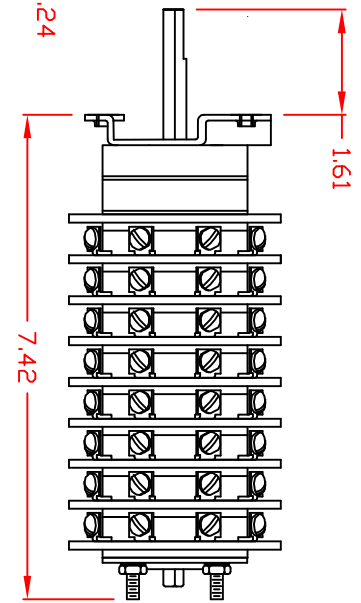
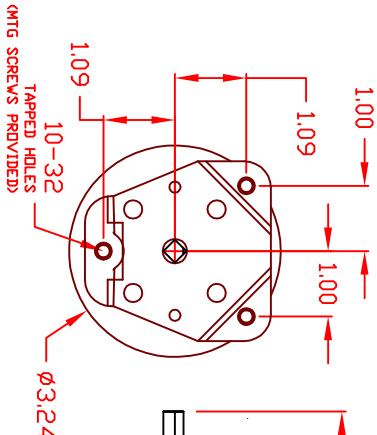

76208D