

General:

Meets requirements for 1 - 25 ampere switching of resistive loads to .75 power factor at voltages to 600 V AC and 250 VDC resistive loads

Electrical:

- * Ratings: 25A/120 VAC
- 15A/600 VAC
- 20A/600 VAC (RESISTIVE)
- 3A/125 VDC
- 1A/250 VDC



- * Current carrying capacity: 25 amperes
- * Dielectric Withstanding Voltage: 2200 Vrms
- * Contact Resistance: Initial, 10 milliohms max.
- * Insulation Resistance: 100 Megohms min., initial

Mechanical:

- * Sections: 1
- * Positions: 2 or 3 (Adjustable by customer). Shaft will spring return to the rest position. (See Table)
- * Indexing: 45°
- * Rotational Life: 65,000 operations

Materials and Finishes:

- * Rotors and Stators: Thermoset Plastic, UL 94VO
- * Rotor contacts: Phosphor bronze
- * Stator contacts: Silver plated copper, screw type
- * Terminal hardware: silver plated brass
- * Exterior Metal: Steel with zinc chromate finish
- * Knob: thermoset phenolic

MOUNTING HOLE DETAIL

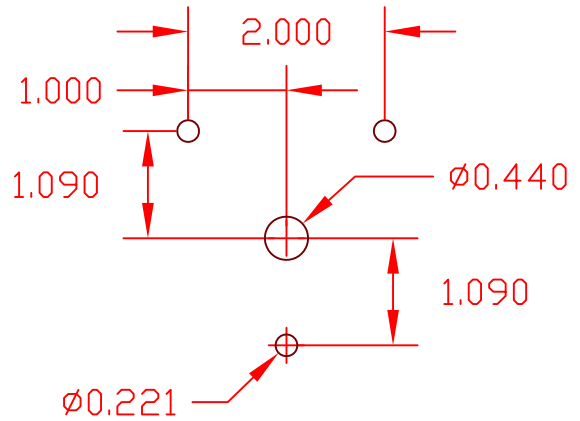

HANDLE

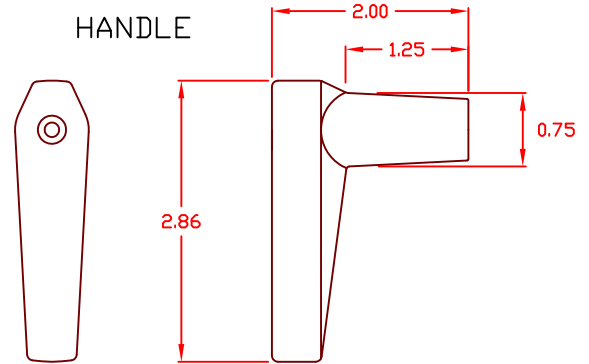

ADJUSTABLE STOPS FOR OPERATION SHOWN

DECK	CONTACTS			POSITION		
	1	2	3	1	2	3
1	18 ○			○ 11	×	
	11 ○			○ 12		×
	12 ○			○ 13		×
	14 ○			○ 15	×	
	15 ○			○ 16		×
	16 ○			○ 17		×

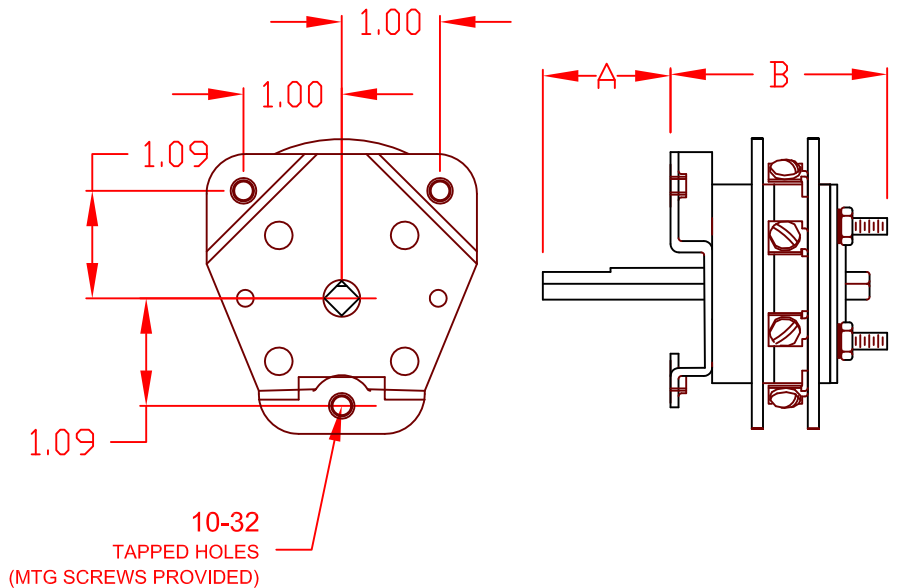

76201D

REV. A

HANDLE TYPE: PISTOL GRIP "A" DIM: 1.6

"B" DIM: 2.41