

General:

Meets requirements for 1 - 25 ampere switching of resistive loads to .75 power factor at voltages to 600 V AC and 250 V DC resistive loads

Electrical:

* Ratings:



- 25A/120 VAC
- 15A/600 VAC
- 20A/600 VAC (RESISTIVE)
- 3A/125 VDC
- 1A/250 VDC

- * Current carrying capacity: 30 amperes
- * Dielectric Withstanding Voltage: 2200 Vrms
- * Contact Resistance: Initial, 10 milliohms max.
- * Insulation Resistance: 100 Megohms min., initial

Mechanical:

- * Sections: 3
- * Positions: 2 (stops set in # 1 & #7)
- * Circuit: See Contact Table and Stator Diagram
- * Nonshorting Operation
- * Indexing: 45° positive detent
- * Rotational Life: 65,000 operations

Materials and Finishes:

- * Rotors and Stators: Thermoset Plastic, UL 94VO
- * Rotor contacts: Phosphor bronze
- * Stator contacts: Silver plated copper, screw type
- * Terminal hardware: silver plated brass
- * Exterior Metal: Steel with zinc chromate finish
- * Knob: thermoset phenolic

CONTACT TABLE

DECK	CONTACTS	POS.	
		1	2
1	11-0-1-1-013	X	
	12-0-1-1-014		X
	15-0-1-1-017	X	
	16-0-1-1-018		X
2	21-0-1-1-023	X	
	22-0-1-1-024		X
	25-0-1-1-027	X	
	26-0-1-1-028		X
3	31-0-1-1-033	X	
	32-0-1-1-034		X
	35-0-1-1-037	X	
	36-0-1-1-038		X

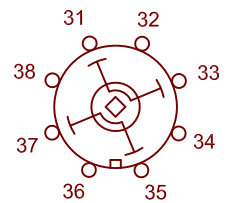
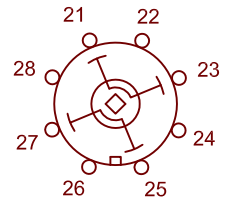
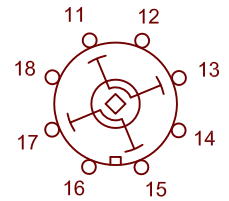

STATOR DIAGRAM

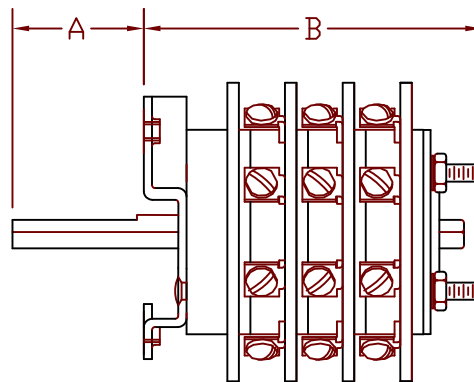
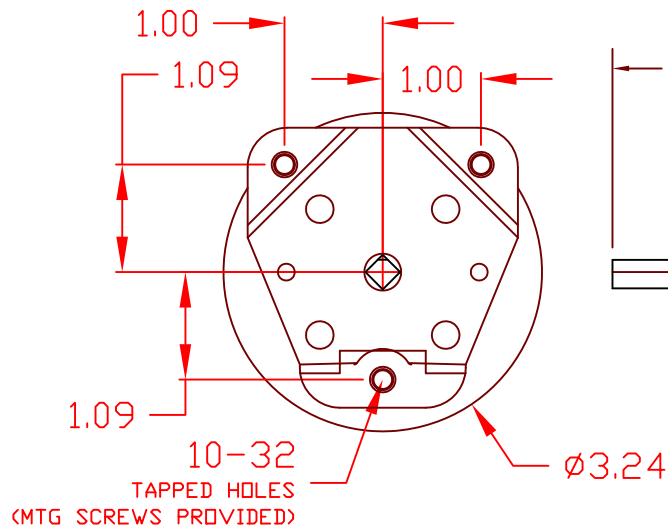
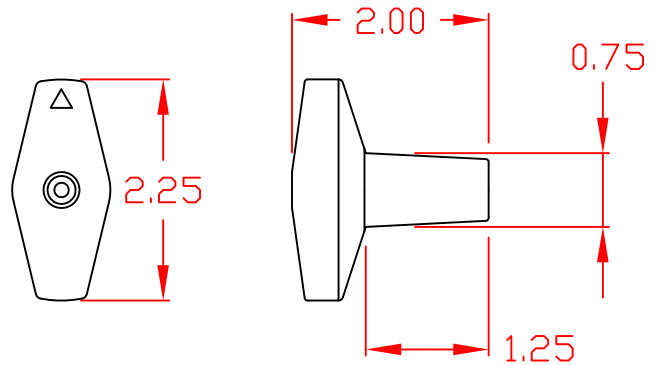

HANDLE TYPE: OVAL "A" DIM: 1.6
 "B" DIM: 3.53

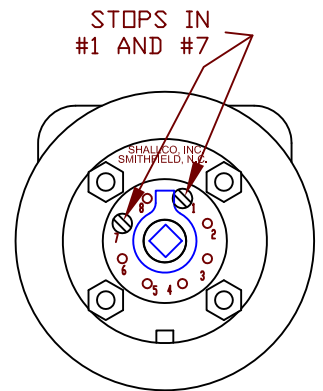

26503B (set for 2 positions)

REV. -